

SUPPLY SHEET

DO-W0911A

1/3" (1024 x 512)

CUSTOMER	APPROVED		
SUPPLIER	Charge	Judgment	Approved

Date : 2010. 09. 01

 **Digital Optics Co., Ltd.**

RM 204, Sicox Tower, 513-14, Sangdaewon-dong, Jungwon-Gu, Seongnam-City, Kyonggi-Do, 462-120, Korea

TEL : 82-31-777-9861 FAX : 82-31-777-9864 <http://www.digitaloptics.co.kr/>

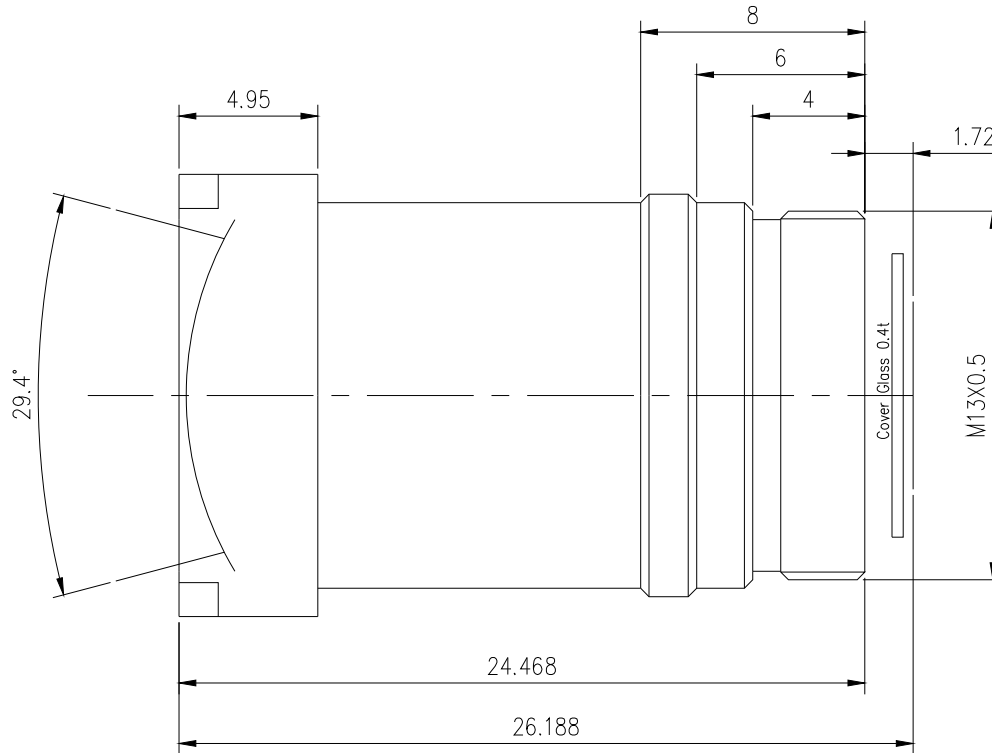

Lens Specifications

USE : 1/3" 1024 x 512 Automotive Lens (Night Vision System)

Focal Length	12.66mm (@ 900nm)	
Relative Aperture (F/#)	1.2	
Sensor Image Size	Ø6.42mm (Max Image Circle : Ø6.8mm)	
Field Of View	29.4°(D), 26.2°(H), 13.0°(V)	
MTF (Design Value)	Center	58.5% (at 60 lp/mm)
	0.7 Field	77.1%(R), 65.1%(T) (at 45 lp/mm)
Total Track Length	26.188mm (from lens top to image surface) (Band Pass Filter t=0.4mm, C/G t=0.4mm)	
Back Focal Length	3.301mm (Band Pass Filter t=0.4mm, C/G t=0.4mm)	
TV Distortion	≤ -1.1%	
Chief Ray Angle(Max)	9.97° (at 1.0 Field)	
Relative Illumination	72.9%	
Construction	5 Glass	
Coating	AR Coating	
Lens Barrel	M13X0.5	